

Push-in fitting type resin body

Check Valve - Inline low cracking pressure

In-Line Back Flow Preventing Valve

Low level
ozone proof

● *Service pressure range from -29.5inHg to 145psi with min. opening differential pressure of 1.45psi (3inHg).*

● *Opening pressure : 0.73psi (5kPa)*

Securing air flow at low pressure that the conventional check valve does not open.

● *Low level ozone proof*

HNBR and FKM for rubber parts.

● *Less noise generation compared to the conventional type.*

No disc type - No spring incorporated.

● *Resin type valve for cost-saving and light-weight*

Model Designation (Example)



In-Line Straight Low Cracking Pressure

RoHS compliant

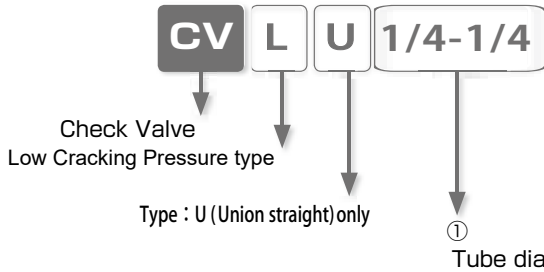

① . Tube dia.

Code	5/32-5/32	1/4-1/4	5/16-5/16	3/8-3/8	1/2-1/2
Size (inch)	ø5/32	ø1/4	ø5/16	ø3/8	ø1/2

Code	4-4	6-6	8-8	10-10	12-12
Size (mm)	ø4	ø6	ø8	ø10	ø12

Specifications

Fluid medium	Air
Max. operating pressure	145psi (1.0MPa)
Max. vacuum	-29.5inHg (-100kPa)
Opening pressure (※1)	0.73psi at 77°F (5kPa at 25°C)
Operating temp. range	32 ~ 140° F (0 ~ 60° C) (no freezing)
Min. opening differential pressure	1.45psi (0.01MPa)

※1. Opening pressure is the initial pressure on the secondary side when the pressure is applied from free flow side.

※2. Check valve permits air leakage. Do not use for the application in which air tightness is required.

※3. Entering of foreign substances in the product may cause leakage at check valve. Make sure to place a filter at upstream side.

Constructions



Symbol

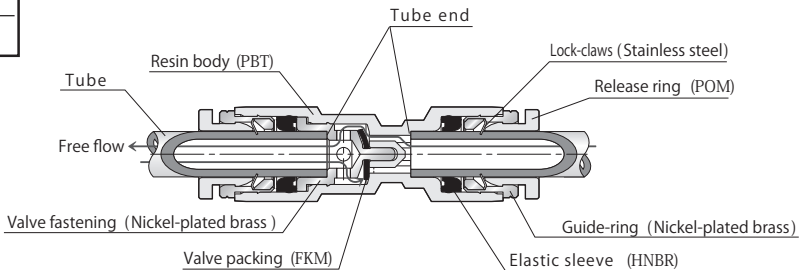

■ Connection: Tube⇔Tube

CVLU In-Line straight

RoHS compliant

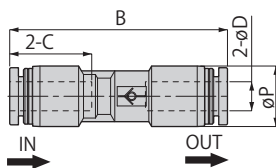
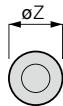

Unit : mm

Model code	Tube O.D. ϕD	ϕZ	B	ϕP	Tube end C	Effective area (mm ²)	Weight (g)
CVLU5/32-5/32	5/32	9.9	38.9	10	14.9	2	5.9
CVLU1/4-1/4	1/4	11.8	45	12.5	17	4.3	8.6
CVLU5/16-5/16	5/16	13.8	50.5	15	18.1	6.4	15
CVLU3/8-3/8	3/8	16.8	58.4	18.5	20.2	12.3	26
CVLU1/2-1/2	1/2	19.8	67.4	21.7	23.7	16.9	38

Model code	Tube O.D. ϕD	B	ϕP	Tube end C	Effective area (mm ²)	Weight (g)	CAD File name
CVLU4-4	4	38.9	10	14.9	2	5.9	CVLU4-4
CVLU6-6	6	45	12.5	17	4.3	8.8	CVLU6-6
CVLU8-8	8	50.5	15	18.1	6.4	15	CVLU8-8
CVLU10-10	10	58.4	18.5	20.2	12.3	25	CVLU10-10
CVLU12-12	12	66.8	21.7	23.4	16.9	39	CVLU12-12

⚠ Detailed Safety Instructions

Before using PISCO products, be sure to read "Safety Instructions" and "Safety Instruction Manual" and "Common Safety Instructions for Controllers".

Warning

1. Frequent switching may generate heat and cause a danger of getting burnt. Contact us in case of using Check Valve with frequent switching.

Caution

1. In case the pressure difference between the primary pressure and secondary pressure is extremely large, it may cause damage to the poppet during operation. The fragment of broken poppet may flow into the secondary side in the worst case.
2. Abnormal noise by chattering poppet may occur, depending on an operation pressure or flow rate.
3. Min. checking differential pressure must be above 10kPa. Use with checking differential pressure under 10kPa may cause leakage.
4. When pressure is applied consecutively in the checking direction, opening pressure may be higher than the catalog specification depending on ambient temperature, pressure applying time and other conditions.

■ How to insert and disconnect

1. How to insert and disconnect tubes

①. Tube insertion

Insert a tube into Push-in fitting up to the tube end. Lock-claws bite the tube and fix it automatically, then the elastic sleeve seals around the tube. Refer to "2. Instructions for Tube Insertion" under "Common Safety Instructions for Fittings".

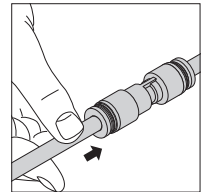

②. Tube disconnection

The tube is disconnected by pushing release-ring to release Lock-claws. Make sure to stop air supply before the tube disconnection.

