

Hollow Fiber Membrane Filter

Best suitable for semiconductor, measuring instruments, printing and medical industries

⚠ Safety instructions for this product

Safety instructions, Common safety instructions for each product category and Detailed safety instructions for each product are in the end of this catalog and our website.

Model Designation (Example)



(1) Hollow Fiber Membrane Filter

(2) Max. operating flow

Code	50	100
Max. operating flow (l/min[ANR])	50	100

(3) IN & Out Tube dia. (øD)

Code	44	66	88	1010
Tube O.D. (mm)	ø4	ø6	ø8	ø10

*1. Code: 44 can be selected only for Max. operating flow of 50l/min [ANR].
*2. Code: 1010 can be selected only for Max. operating flow of 100l/min [ANR].

(4) Holder option

Code	No code	-NH
Holder option	With Holder	Without Holder

Characteristics

The filtration accuracy of 0.01µm and trapping efficiency of 99.99% has been realized.

Adopting the hollow fiber to the filter.

The small size and light weight filter handling the large flow.

Equipped with Blast shelter function.

The main plastic body covering the filter case.

Oil-free specification with stainless steel body.

• Clean-room pkg. (Standard spec.)

Best suitable for piping in clean environment.

The products are washed by clean air, then packed in ISO class 6 equivalent clean-room

Specifications

Type	MFU50-44	MFU50-66	MFU50-88	MFU100-66	MFU100-88	MFU100-1010
Max. operating flow *2	50 l/min [ANR]			100 l/min [ANR]		
Membrane area	107 cm ²			215 cm ²		
Fluid medium *3	Air, Nitrogen					
Max. operating pressure *1	1.0 MPa (at 20°C)					
Operating temp. range	5 to 50°C					
Filtering accuracy *4	0.01 µm (Trapping efficiency: 99.99%)					
Pressure Resistance	1.5 MPa (at 20°C)					
Differential Pressure resistance	0.25 MPa (at 20°C)					
Filter area	4.7 cm ²		7.5 cm ²			12.7 cm ²
Remark	with Explosion-Proof Cover, Oil-Free spec.					

⚠ Warning

*1. When the product is used beyond the operating temperature range, refer to "Relation of Operating Temp. & Max. Operating Pressure" before using. When the fluid medium is nitrogen, the max. operating pressure is 0.99MPa at 20°C.

⊕ Notes

*2. The primary pressure: Pressure loss at 0.7MPa; the air flow would become that of 0.03MPa. The maximum operating flow differs depending on the tube fitting's size.
*3. When the fluid medium is other than the above, contact us for details before using.
*4. Based on PISCO measuring condition.

RoHS2 (2011/65/EU+EU2015/863) compliant

Type	Model code
Hollow Fiber Membrane Filter MFU øD	MFU[2]-øDøD-[4]
	MFU50-44-[4]
	MFU50-66-[4]
	MFU50-88-[4]
	MFU100-66-[4]
	MFU100-88-[4]
	MFU100-1010-[4]

Replacement parts

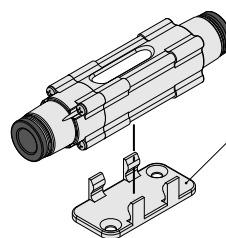

Holder

Hollow Fiber Membrane Filter type	Holder Model code
MFU50-□	MFUH050P01
MFU100-□	MFUH100P01

Sectional drawing

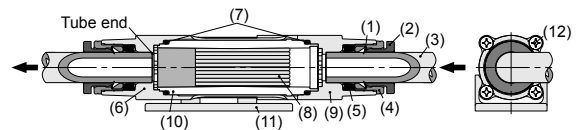

No.	Parts	Material
(1)	Lock claws	Stainless steel
(2)	Release-ring	PBT
(3)	Tube	Polyurethane, Nylon, etc
(4)	Guide ring	SUS304
(5)	Elastic sleeve	FKM
(6)	Casing1	PBT
(7)	O-ring	FKM
(8)	Hollow fiber membrane	PP
(9)	Casing2	PBT
(10)	Filter case	PA
(11)	Holder	POM
(12)	Screws	SUS304

Relation of Operating Temp. & Max. Operating Pressure

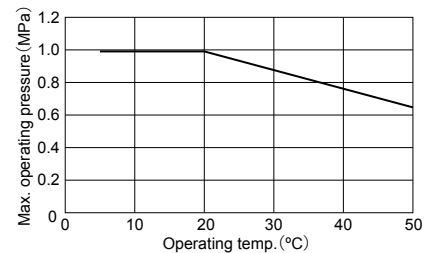

CAD data is available at PISCO website.

Packaging specifications
1 pc. /bag

Standard options
[4] : -HN ⇒ Without holder